



Acoustical Surfaces, Inc.

SOUNDPROOFING, ACOUSTICS, NOISE & VIBRATION CONTROL SPECIALISTS
123 Columbia Court North • Suite 201 • Chaska, MN 55318
(952) 448-5300 • Fax (952) 448-2613 • (800) 448-0121
Email: sales@acousticalsurfaces.com
Visit our Website: www.acousticalsurfaces.com

We Identify and **S.T.O.P.** Your Noise Problems

Studio 3D Door Hardware



Always precise

One Motion™ System Overview

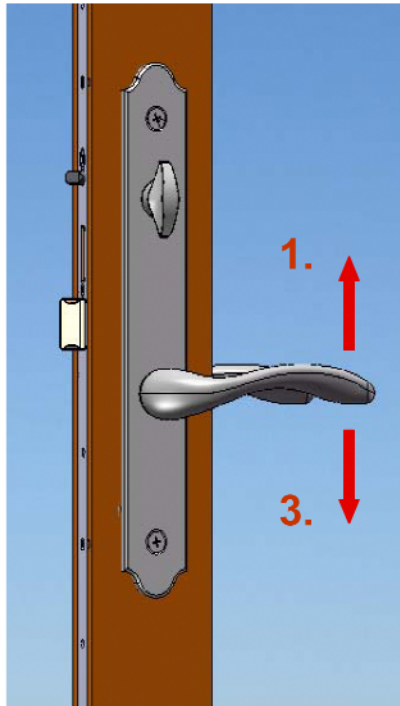

1. Single Upward Motion

- One upward motion of the handle engages all locking points

2. 90° Deadbolt Turn

- Intuitive user friendly lock and unlock thumb turn
- Vertical position indicates door is unlocked
- Horizontal position indicates door is locked

3. Auto-Unlock from Inside

- No deadbolt turning is required to exit a locked door
- With one downward motion all locking points are unlocked and latch is retracted from the inside

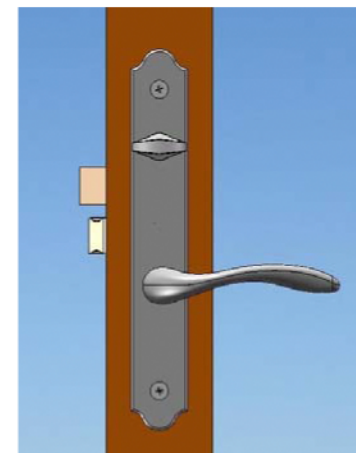
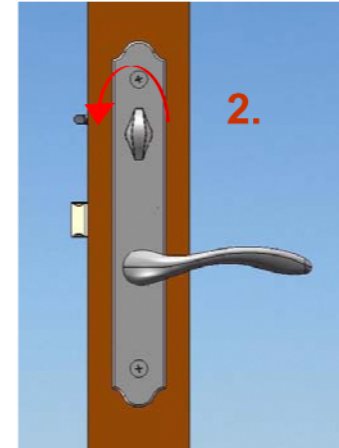



Acoustical Surfaces, Inc.

SOUNDPROOFING, ACOUSTICS, NOISE & VIBRATION CONTROL SPECIALISTS
123 Columbia Court North • Suite 201 • Chaska, MN 55318
(952) 448-5300 • Fax (952) 448-2613 • (800) 448-0121
Email: sales@acousticalsurfaces.com
Visit our Website: www.acousticalsurfaces.com

We Identify and **S.T.O.P.** Your Noise Problems

Studio 3D Door Hardware



Always precise

One Motion™ Features

Stainless Steel Faceplate

- 300 series stainless steel for maximum corrosion resistance

Anti-Slam Feature

- Prevents hooks and deadbolt from extending when door is opened
- Prevents accidental damage to door frame

Solid Brass 1" Deadbolt



Easy Key Access

- Cylinder located above the handle
- Sleek and clean appearance
- Schlage C Keyway (Re-Keyable)
- 8 mm solid brass shaft



Keyed
Cylinder



Non-Keyed
Cylinder



Acoustical Surfaces, Inc.

SOUNDPROOFING, ACOUSTICS, NOISE & VIBRATION CONTROL SPECIALISTS
123 Columbia Court North • Suite 201 • Chaska, MN 55318
(952) 448-5300 • Fax (952) 448-2613 • (800) 448-0121
Email: sales@acousticalsurfaces.com
Visit our Website: www.acousticalsurfaces.com

We Identify and **S.T.O.P.** Your Noise Problems

Studio 3D Door Hardware

Always precise **WINK
HAUS**

One Motion™ Features Cont.

Hook Design

- 2-dimensional closing force
 - pulls the panel closed
 - interlocks the panel to the jam
- Hooks sequentially pull the panel closed
- Two hooks are available above the handle for 8'+ doors
- Positive engagement with strikes

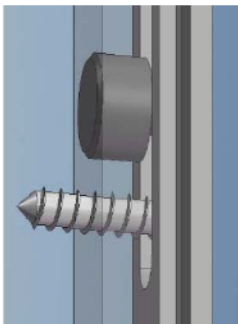

Screw Supports

- Located within the Euro Groove
- Prevents the faceplate and drive rail from bending during installation
- Assures smooth operation

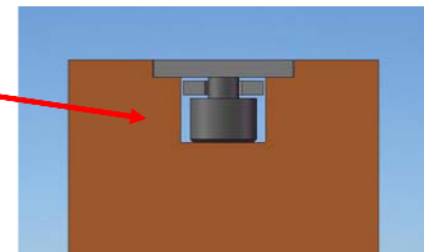



Acoustical Surfaces, Inc.

SOUNDPROOFING, ACOUSTICS, NOISE & VIBRATION CONTROL SPECIALISTS
123 Columbia Court North • Suite 201 • Chaska, MN 55318
(952) 448-5300 • Fax (952) 448-2613 • (800) 448-0121
Email: sales@acousticalsurfaces.com
Visit our Website: www.acousticalsurfaces.com

We Identify and **S.T.O.P.** Your Noise Problems

Studio 3D Door Hardware



Always precise

French Doors & One Motion™



- Passive door panel has integrated receiver plates
- T-astragal is not required for French doors





Acoustical Surfaces, Inc.

SOUNDPROOFING, ACOUSTICS, NOISE & VIBRATION CONTROL SPECIALISTS
123 Columbia Court North • Suite 201 • Chaska, MN 55318
(952) 448-5300 • Fax (952) 448-2613 • (800) 448-0121
Email: sales@acousticalsurfaces.com
Visit our Website: www.acousticalsurfaces.com

We Identify and **S.T.O.P.** Your Noise Problems

Studio 3D Door Hardware



Always precise

PVD - Physical Vapor Deposition

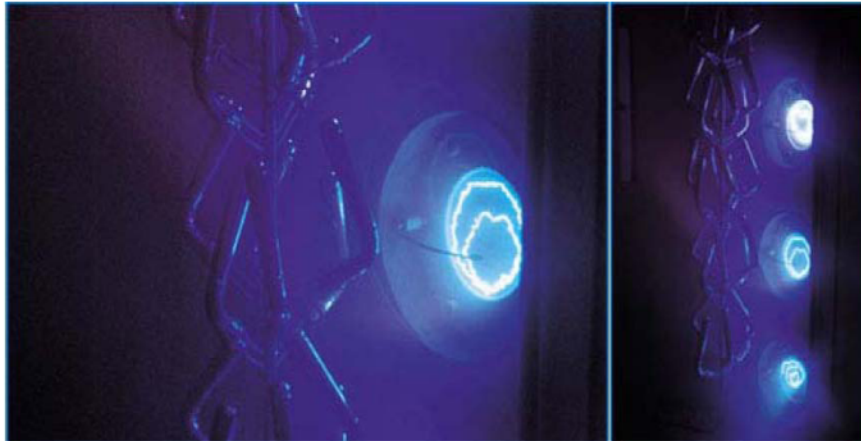

Characteristics

- Extremely Hard surfaces (2500/300 HV)
- Highly corrosion resistant; over 1500 hours in salt spray solution without any surface alteration
- Double the durability of a normal chrome plating
- Resistant to solvents, acids, or alkali products
- No degradation in U.V. light
- Provides superior wear resistance, abrasion resistance, and chemical resistance

**Winkhaus
offers a
Limited Lifetime Warranty
on PVD Finishes**



PVD Bronze
Special Order
6 Additional
Hardware Colors



PVD Ultra Steel
Standard Color
Hardware



PVD Bright Brass
Standard Color
Hardware



Acoustical Surfaces, Inc.

SOUNDPROOFING, ACOUSTICS, NOISE & VIBRATION CONTROL SPECIALISTS
123 Columbia Court North • Suite 201 • Chaska, MN 55318
(952) 448-5300 • Fax (952) 448-2613 • (800) 448-0121
Email: sales@acousticalsurfaces.com
Visit our Website: www.acousticalsurfaces.com

We Identify and **S.T.O.P.** Your Noise Problems

Studio 3D Door Hardware



Always precise

Botticelli



Standard Hardware

Fontana



Special Order Hardware

Mercury



Special Order Hardware



Acoustical Surfaces, Inc.

SOUNDPROOFING, ACOUSTICS, NOISE & VIBRATION CONTROL SPECIALISTS
123 Columbia Court North • Suite 201 • Chaska, MN 55318
(952) 448-5300 • Fax (952) 448-2613 • (800) 448-0121
Email: sales@acousticalsurfaces.com
Visit our Website: www.acousticalsurfaces.com

We Identify and **S.T.O.P.** Your Noise Problems

Studio 3D Door Hardware



Always precise

Pegasus



Special Order Hardware

Riccio



Special Order Hardware

Volo



Special Order Hardware



Acoustical Surfaces, Inc.











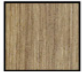



SOUNDPROOFING, ACOUSTICS, NOISE & VIBRATION CONTROL SPECIALISTS
 123 Columbia Court North • Suite 201 • Chaska, MN 55318
 (952) 448-5300 • Fax (952) 448-2613 • (800) 448-0121
 Email: sales@acousticalsurfaces.com
 Visit our Website: www.acousticalsurfaces.com

We Identify and **S.T.O.P.** Your Noise Problems

Studio 3D Door Hardware



Winkhaus One Motion™ MPL System Trimset Availability - Swing Doors

								
Handles	Antique Brass	PVD Bright Brass	White	Flat Black	Bright Chrome	PVD Ultra Steel	Oil Rubbed Brass	PVD Bronze
Fontana 	X	X	X	X	X	X	X	X
Botticelli 	X	X	X	X	X	X	X	X
Pegasus 	X	X	X	X	X	X		X
Mercury 		X - Brushed / Bright Brass (Split)			X - Brushed / Bright Chrome (Split)	X		
Volo 	X	X	X	X	X	X	X	X
Riccio 	X	X				X		X
Escutcheons	Antique Brass	PVD Bright Brass	White	Flat Black	Bright Chrome	PVD Ultra Steel	Oil Rubbed Brass	PVD Bronze
STN - Curved Top	X	X	X	X	X	X	X	X
STV - Traditional	X	X	X	X	X	X		X
STQ - Square Corners	X	X	X	X	X	X	X	X

