

FRONT VIEW



SECTION VIEW

**Materials Included**

- Window frame
- Snap-fit glass retainers
- Glass unit
- Rubber setting blocks for glass
- Small block of wood for installing glass retainers

**Recommended Installation Kit Includes**

- Shims
- Screws
- Acoustical Sealant
- Backer Rod

**Helpful tools during installation**

- Drill
- Rubber mallet
- Protective gloves with enhanced grip
- Suctions cups for glass handling (may be required for large units)

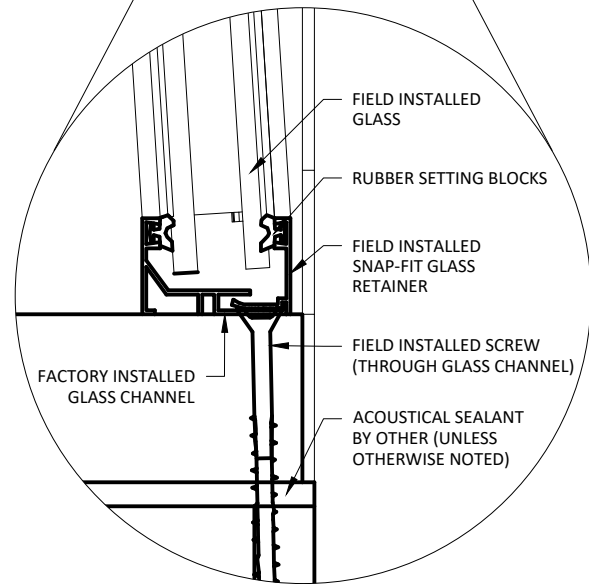

**Delivery:**

Upon delivery and before signature make sure that the crate and packaging show no signs of damage. If there is any apparent damage, contact ASI immediately at 1-800-710-8106.

1

**Important Notes**

- Any breakage of glass during shipment must be reported to ASI upon delivery, before signing for freight to be covered under freight insurance.
- Close crate to protect glass from accidental damage before glass installation.

Unscrew board supports from glass crate while another person holds the glass crate upright.



2

With the help of another person, carefully lift glass crate from pallet.



3

Gently lean up against a flat wall surface



123 Columbia Court North, Chaska,  
Minnesota 55318 P. 800.527.6253

STUDIO WINDOW INSTALLATION INSTRUCTIONS  
UNPACKING STEPS 1-3

SCALE: NOT TO SCALE

LAST REVISED: 12/3/2019

DRAWN BY: BH

SHEET NUMBER

2

DO NOT SCALE DRAWING. FIGURED DIMENSIONS ARE TO BE FOLLOWED. READ THIS DRAWING IN CONNECTION WITH GENERAL ARCHITECTURAL PLANS, STRUCTURAL PLANS, AND OTHER RELATED DRAWINGS. THESE DRAWINGS REPRESENT ASI'S UNDERSTANDING AND INTERPRETATION OF THE ARCHITECTURAL DRAWINGS AND HOW ASI PRODUCTS RELATE TO THE PROJECT. COPYRIGHT ASI © 2019

4

Remove the screws from the exposed side of glass crate.



5

**IMPORTANT:** Inspect glass to make sure it is not damaged.



1

Place 1/4" shims in bottom of opening and tack into place. Place frame into opening, center and level with remaining shims.



2

Predrill holes in frame through glass channel as shown at shim locations and install mounting screws



3

Apply sealant backer material between the outside of frame and wall opening. Recess 1" into gap to allow space for acoustical sealant.

Fill the gap with acoustical sealant between window frame and opening on all four sides completely to eliminate any sound leaks.



4

Apply window trim if required.



123 Columbia Court North, Chaska,  
Minnesota 55318 P. 800.527.6253

## STUDIO WINDOW INSTALLATION INSTRUCTIONS FRAME INSTALL STEPS 3-4

SCALE: NOT TO SCALE

LAST REVISED: 12/3/2019

DRAWN BY: BH

SHEET NUMBER

5

DO NOT SCALE DRAWING. FIGURED DIMENSIONS ARE TO BE FOLLOWED. READ THIS DRAWING IN CONNECTION WITH GENERAL ARCHITECTURAL PLANS, STRUCTURAL PLANS, AND OTHER RELATED DRAWINGS. THESE DRAWINGS REPRESENT ASI'S UNDERSTANDING AND INTERPRETATION OF THE ARCHITECTURAL DRAWINGS AND HOW ASI PRODUCTS RELATE TO THE PROJECT. COPYRIGHT ASI © 2019

**GLASS INSTALL NOTE:** This will be at least a 2 person job and may need to be installed by a professional glazing contractor depending on the scope of the project.

**NOTE:** If you are installing a Studio 6 window; it has an additional piece of glass; make sure you clean the inside surfaces of each completely. After installation the inside surfaces of the glass will be inaccessible.

**IMPORTANT GLASS HANDLING:** Glass should always be handled wearing gloves and/or using suction cups if needed and placed vertically on, or against a flat cushioned surface (carpet, rubber, foam, etc.); never pickup flat or set directly on or against a hard surface or breakage may occur.

1

Place rubber setting pads on bottom surface of the glass channel about 4" in from the corners. (Some glue or two-sided tape will help hold them in place during glass installation)



2

Wearing gloves and/or using suction cups, lift the glass into place and rest the bottom edge on the two setting pads and up against the rubber seal on the inside of the window jamb. Gently tilt the top of the glass into place making sure it is centered in the opening.



123 Columbia Court North, Chaska,  
Minnesota 55318 P. 800.527.6253

## STUDIO WINDOW INSTALLATION INSTRUCTIONS GLASS INSTALL STEPS 1-2

SCALE: NOT TO SCALE

LAST REVISED: 12/3/2019

DRAWN BY: BH

SHEET NUMBER

6

DO NOT SCALE DRAWING. FIGURED DIMENSIONS ARE TO BE FOLLOWED. READ THIS DRAWING IN CONNECTION WITH GENERAL ARCHITECTURAL PLANS, STRUCTURAL PLANS, AND OTHER RELATED DRAWINGS. THESE DRAWINGS REPRESENT ASI'S UNDERSTANDING AND INTERPRETATION OF THE ARCHITECTURAL DRAWINGS AND HOW ASI PRODUCTS RELATE TO THE PROJECT. COPYRIGHT ASI © 2019

3

While holding glass in place, install aluminum glass retainer by setting it into the glass gutter. Glass retainer should be snapped into place by pressing it in with a piece of blocking or gently tapping it with a rubber mallet.



4

Repeat step 3 for each glass retainer until all are snapped in tight.



5

Installation is complete

